

FRIGA-BOHN®

XR

Ceiling or wall-mounted unit cooler  
Commercial range

HFC



|||| 370 - 1050 kW



- # **Compact design** and **ceiling or wall mounting possible** for perfect integration in small spaces and optimization of the storage area.
- # "Keyhole" fixing and drilling template printed on the cardboard packaging to **save installation time**.
- # Access to all components from the front for **easy maintenance**.

## COILS

- # Aluminium fins with 4.23 mm spacing and sinusoidal profile.
- # Combined with copper tubes with a grooved internal structure, the coils are very efficient and compact.
- # Coils completely covered with polyester protection as standard.



Ceiling mounting

## CASING

- # Galvanized sheet steel and plastic drain pan, white colour.
- # Intermediate drain pan for ceiling mounting, limiting water condensation.



Wall mounting

## VENTILATION

- # Single-phase motor fans, 230 V, 50-60 Hz, Ø 200 mm, protected by an enclosed casing, delivered with cable 3 x 0.75 mm<sup>2</sup> length 1 m:
  - 4P / 1,500 rpm (low noise level).
  - 2P / 3,000 rpm, motor with built-in thermal protection (high performance).

## ADVANTAGES

- # "Keyhole" fixing requiring only one operator.
- # Drilling template printed on the cardboard packaging.
- # 8 pre-cut holes for the tubes and cables.
- # Factory delivered for ceiling mounting, simple conversion for wall mounting.
- # 4 possible drain tube positions with ceiling mounting (2 with wall mounting) to offer the user the maximum available volume.
- # Access to all components from the front.

## DEFROST

	+10	+2	-5	-25°C
tA1	XR ...	+E1K	+ E1K <sup>(1)</sup>	

### OPTION

#### E1K

Electric defrost.

**KIT TO INSTALL**

*(1) **ATTENTION** use SC3 for ceiling mounting only: E1K kit must be mounted.*

# XR<sup>(A)</sup> 60<sup>(B)</sup>

(A) Ceiling or wall-mounted unit cooler  
(B) Model

The XR is available with HFCs.  
For more information,  
please consult our software.

## XR

 4.23 mm

CONDITIONS	REFRIGERANTS	XR ...
SC2	R449A	W
	R404A	W

60	72	80	85	90	100	105	122
470	600	660	680	770	820	900	1050
500	620	660	720	770	830	900	1030

CONDITIONS	REFRIGERANTS	XR ...
SC3	R449A	W
	R404A	W

60	72	80	85	90	100	105	122
370	490	560	570	650	670	730	870
440	550	580	640	680	730	780	900

Surface area		<b>m<sup>2</sup></b>
Circuit volume		<b>dm<sup>3</sup></b>
Airflow		<b>m<sup>3</sup>/h</b>
	Air throw (2)	<b>m</b>
Fan 230V/1/50-60 Hz Ø 200 mm		<b>Nb</b>
		<b>tr/min</b>
230V/1/50Hz	<b>W total</b>	
	<b>A total</b>	
Electric defrost EIK (3)		<b>Nb</b>
	230V/1/50Hz	<b>W total</b>
		<b>A total</b>
Connections	Inlet (4)	<b>Ø ODF</b>
	Outlet (4)	<b>Ø ODF</b>
Net weight		<b>kg</b>

60	72	80	85	90	100	105	122
1,5	2,0	2,5	2,0	3,0	2,5	3,0	3,8
0,3	0,3	0,4	0,3	0,5	0,4	0,5	0,7
270	250	230	440	360	410	500	480
2,5	2,0	2,0	3,0	2,0	3,0	2,5	2,5
1	1	1	1	1	1	1	1
1500	1500	1500	3000	1500	3000	3000	3000
43	43	43	80	43	80	80	80
0,25	0,25	0,25	0,50	0,25	0,50	0,50	0,50
1	1	1	1	1	1	1	1
400	400	400	400	600	400	600	600
1,8	1,8	1,8	1,8	2,7	1,8	2,7	2,7
3/8"	3/8"	3/8"	3/8"	3/8"	3/8"	3/8"	3/8"
10mm	10mm	10mm	10mm	10mm	10mm	10mm	10mm
3/8"	3/8"	3/8"	3/8"	3/8"	3/8"	3/8"	3/8"
10mm	10mm	10mm	10mm	10mm	10mm	10mm	10mm
7	8	8	8	10	8	10	10

(1) Standard conditions:  
SC2 / 0 °C (air inlet temp.) / -8 °C (evaporating temp.) / DT1 = 8K  
SC3 / -18 °C (air inlet temp.) / -25 °C (evaporating temp.) / DT1 = 7K  
(2) When the section allows air circulation (see CECOMAF GT 6001, DIN8955, ENV328).  
(3) ATTENTION use SC3 for ceiling mounting only: EIK kit must be mounted.  
(4) ODF: female to receive the tube of the same diameter.

R404A is a refrigerant only available for non-EU markets (not compatible with F-Gas).

XR | Ceiling mounting

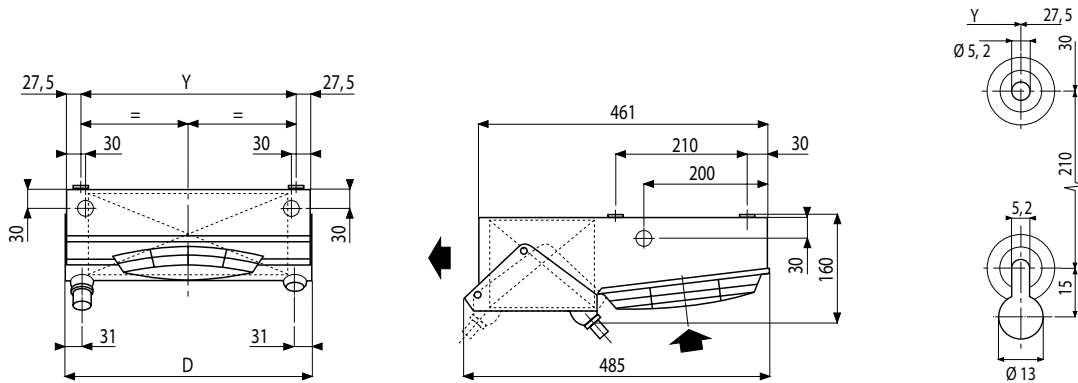

XR | Wall mounting

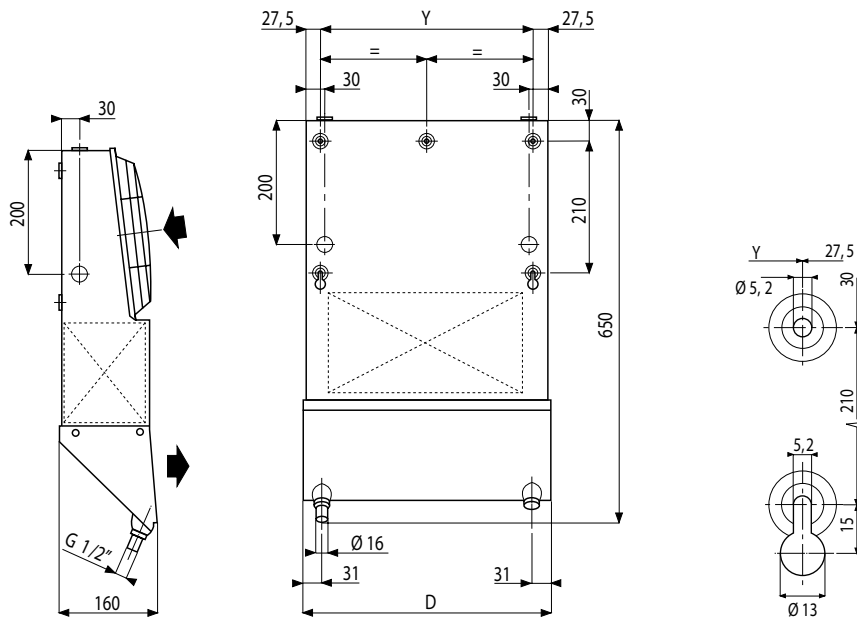

XR

XR ...

 4.23 mm

		60	72	80	85	90	100	105	122
<b>D</b>	<b>mm</b>	399	399	399	399	560	399	560	560
<b>Y</b>	<b>mm</b>	330	330	330	330	485	330	485	485